

FR90

FR90



Thermally insulated fire protection system. Structures designed on the basis of the FR90 system feature fire rating EI30 (E.), EI60 (E.).

FR90

Thermally insulated fire protection system. Structures designed on the basis of the FR90 system feature fire rating EI30 (E_i), EI60 (E_i).

System description:

- Installation depth: 90 mm
- Symmetrically designed profile, inner chamber filled with gypsum infill elements (between thermal separation sheets) – for EI30; all chambers filled with gypsum – for EI60
- Compatible with systems with the installation depth of 90 mm (STAR)
- Possibility of using a triple glazing unit (glazing: 20 mm to 68 mm)
- Option of panel infill (panel thickness 60 mm):
 - mineral wool filled panels (Up = 0,57 W/m²K)
 - gypsum filled panels;
- Application: indoor and outdoor installations
- Structures: single and double doors, fixed glazing
- Maximum dimensions of the tested structure: 6000 x 3000 mm (fixed wall, single glass pane)
- Maximum dimensions of single-leaf doors: 1650 x 2870 mm
- Maximum dimensions of double-leaf doors: 3170 x 2870 mm
- Single-point and multi-point door locks, electric door strikes
- Cover plate hinges, roller hinges
- Solutions with and without thresholds
- Door kick plates (high plinth block)
- Option of air vent installation
- Optimised profiles (one profile type for the door frame and leaf)
- Quick and simple prefabrication (no processing of the glazing bar)
- Acoustics – acoustic testing of double doors featuring fire rating EI30 and EI60 for indoor and outdoor installations: 39 to 47 dB.

A wide range of colours available - RAL palette (Qualicoat 1518), structural colours, Aliplast Wood Colour Effect (Qualideco PL-0001), anodized (Qualanod 1808), bi-colour.

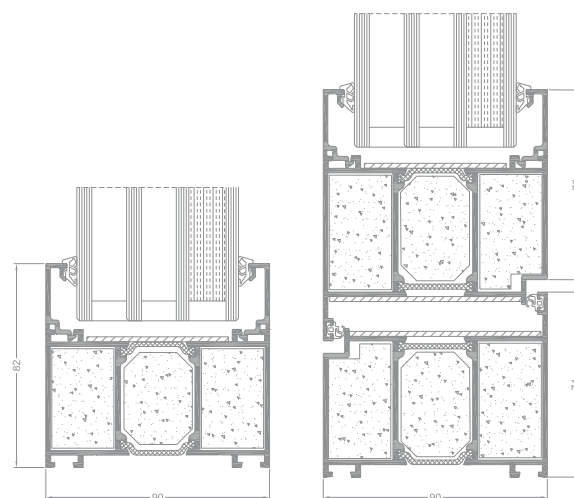

FR90 fix section

FR90 door section

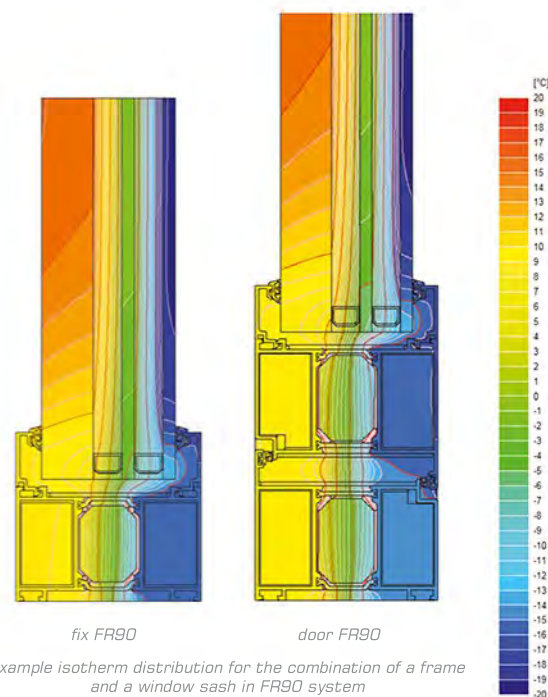

fix FR90

door FR90

example isotherm distribution for the combination of a frame and a window sash in FR90 system

TECHNICAL SPECIFICATION

SYSTEM	MATERIAL	DEPTH OF FRAME	DEPTH OF LEAF	GLAZING RANGE	TYPE OF WINDOWS	TYPE OF DOORS
FR90 fix	aluminium / polyamid	90 mm	—	fix 20 - 68 mm	fix	—
FR90 door	aluminium / polyamid	90 mm	90 mm	door 20 - 68 mm	—	single and double doors

PERFORMANCE

SYSTEM	THERMAL INSULATION Uf *	AIR PERMEABILITY	WINDLOAD RESISTANCE	WATERTIGHTNESS
FR90	Uf from 2,145 W/m ² K	Class 4; EN 12207	C1 (400 Pa); EN 12210	A4 (150 Pa); EN 12208

* Thermal insulation is dependent on a combination of profiles and thickness of the filling.